



BEACH HOUSE 8

GROUND FLOOR



ALL DEPICTIONS OF APPLIANCES, COUNTERTOPS, SOFFITS, FLOOR COVERINGS AND OTHER MATTERS OF DETAIL, INCLUDING, WITHOUT LIMITATION, ITEMS OF FINISH AND DECORATION, ARE CONCEPTUAL ONLY AND ARE NOT NECESSARILY INCLUDED IN EACH UNIT. STATED DIMENSIONS ARE MEASURED TO THE EXTERIOR FACE OF EXTERIOR WALLS AND TO THE EXTERIOR FACE OF WALLS ADJOINING CORRIDORS OR OTHER COMMON ELEMENTS. THIS METHOD OF MEASUREMENT VARIES FROM AND IS LARGER THAN THE DIMENSIONS THAT WOULD BE DETERMINED BY USING THE DESCRIPTION AND DEFINITION OF THE "UNIT" SET FORTH IN THE DECLARATION (WHICH GENERALLY ONLY INCLUDES THE INTERIOR AIRSPACE BETWEEN THE PERIMETER WALLS AND EXCLUDES INTERIOR STRUCTURAL COMPONENTS) FOR YOUR REFERENCE. THE AREA OF THE UNIT, DETERMINED IN ACCORDANCE WITH THOSE DEFINED UNIT BOUNDARIES, IS FOR THE TYPICAL UNIT AT THE GREATEST POINTS OF EACH GIVEN ROOM AS IF THE ROOM WERE A PERFECT RECTANGLE. WITHOUT REGARD FOR ANY CUTOUTS. ACCORDINGLY, THE AREA OF THE ACTUAL ROOM WILL TYPICALLY BE SMALLER THAN THE PRODUCT OBTAINED BY MULTIPLYING THE STATED LENGTH TIMES WIDTH. ALL DIMENSIONS ARE APPROXIMATE AND MAY VARY WITH ACTUAL CONSTRUCTION, AND ALL FLOOR PLANS AND DEVELOPMENT PLANS ARE SUBJECT TO CHANGE.

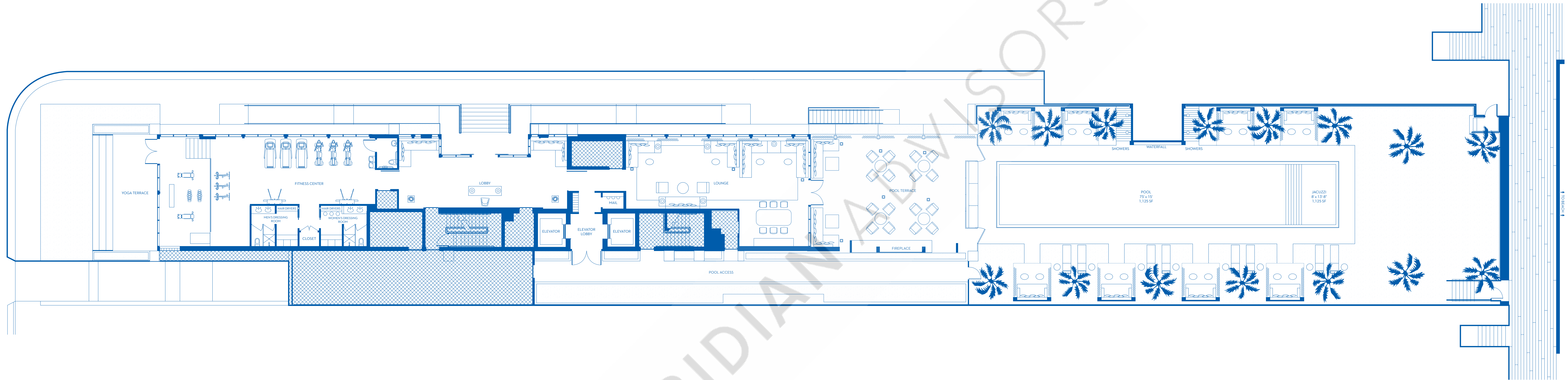

CONCIERGE

Beach House 8 features exclusive concierge service providing unparalleled access to a myriad of services, including dining, entertainment, travel, move-in coordination, cultural events, and other unique service requests.

ON-SITE UNDERGROUND PARKING

Each residence includes two exclusive parking spaces located in the underground parking level with 24/7 valet service.

PRIVATE CABANAS

Each residence has an 8 by 6 foot-wide private poolside cabana featuring privacy curtains, chaise lounge, towel service and mini bar.

LOUNGE & POOL TERRACE

A comfortable seating and social dining area, cozy fireplace, library and game room for residents and their guests.

FITNESS

Ground level features a state-of-the-art Technogym, outdoor yoga terrace, 75-foot pool and jacuzzi.

NORTH ^

1/8" : 1' 